

**FTT**

**LEFT / RIGHT  
GAUCHE / DROITE  
LINKS / RECHTS**

SPARE PARTS



**LINKS / RECHTS**

SPARE PARTS



**Contents**

|   |    |
|---|----|
| Transport system Page 1 .....                     | 3  |
| Transport system Page 2 .....                     | 4  |
| Wash module 1400 .....                            | 5  |
| Strainers + Drains .....                          | 6  |
| Tank heating + Float switch .....                 | 7  |
| Wash system .....                                 | 8  |
| Blower + Rinse .....                              | 9  |
| Booster el heated .....                           | 10 |
| Booster 0.5m <sup>2</sup> hot water + Steam ..... | 11 |
| Tankheating hot water + Steam .....               | 12 |
| Panels + Insulation wash module 1400 .....        | 13 |
| Dryer module 850 .....                            | 14 |
| Panels + Insulation dryer module 850 .....        | 15 |
| Condenser .....                                   | 16 |
| Exhaust extracion - Fan .....                     | 17 |
| Tray Stacker .....                                | 18 |
| Tray stacker with buffer stacker .....            | 19 |

**Sommaire**

|   |    |
|---|----|
| Systeme de transport Page 1 .....                     | 3  |
| Systeme de transport Page 2 .....                     | 4  |
| Module de levage 1400 .....                           | 5  |
| Filtres - Vidange .....                               | 6  |
| Chauffage du bac + Interrupteur à flotteur .....      | 7  |
| Systeme de lavage .....                               | 8  |
| Pre-soufflage + Rincage .....                         | 9  |
| Chaudière électrique .....                            | 10 |
| Chaudière 0.5m <sup>2</sup> eau chaude + Vapeur ..... | 11 |
| Chaudière du bac eau chaud + Vapeur .....             | 12 |
| Habillage + Isolation module de lavage 1400 .....     | 13 |
| Module de sechage 850 .....                           | 14 |
| Habillage + Isolation module de sechage 850 .....     | 15 |
| Condenseur .....                                      | 16 |
| Extraction des buées - Ventilateur .....              | 17 |
| D'extraction system des plateaux .....                | 18 |
| Empilage de plateaux (final et intermédiaire) .....   | 19 |

**Inhalt**

|  |    |
|--|----|
| Transportsystem Blatt 1 .....                        | 3  |
| Transportsystem Blatt 2 .....                        | 4  |
| Waschmodul 1400 .....                                | 5  |
| Sieb + Ablauf .....                                  | 6  |
| Tankheizung + Schwimmer-Schalte .....                | 7  |
| Waschsystem .....                                    | 8  |
| Vorausblasung + Spülung .....                        | 9  |
| Durchlauferhitzer el. beheizt .....                  | 10 |
| Durchlauferhitzer 0.5m <sup>2</sup> HW + Dampf ..... | 11 |
| Tankheizung HW + Dampf .....                         | 12 |
| Verkleidungen + Isolation Waschmodul 1400 .....      | 13 |
| Trockenmodul 850 .....                               | 14 |
| Verkleidungen + Isolation Trockenmodul 850 .....     | 15 |
| Kondensator .....                                    | 16 |
| Wrasenabzug - Ventilator .....                       | 17 |
| Abstapelung .....                                    | 18 |
| Abstapelung mit Zwischenstapel-Einrichtung .....     | 19 |

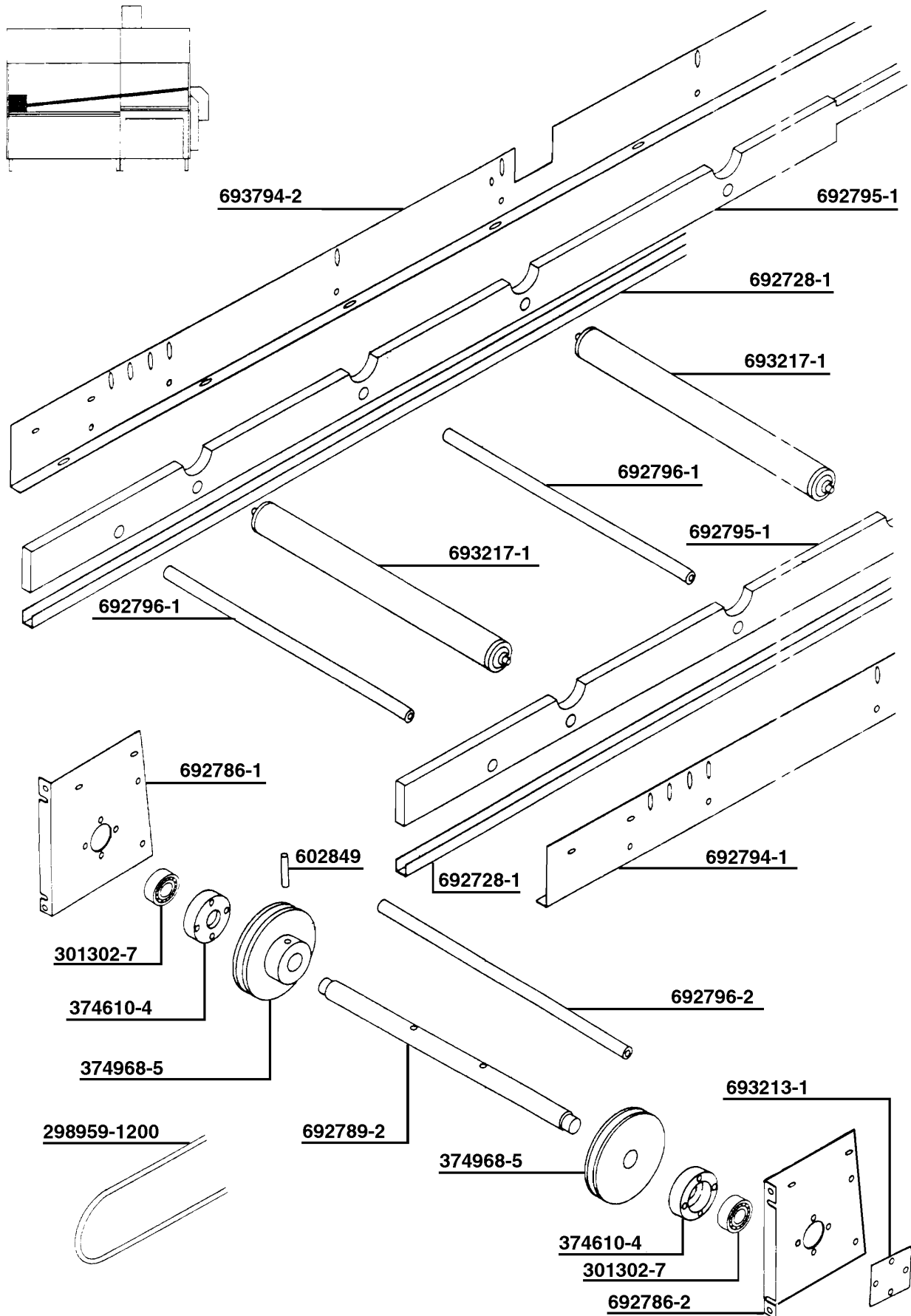

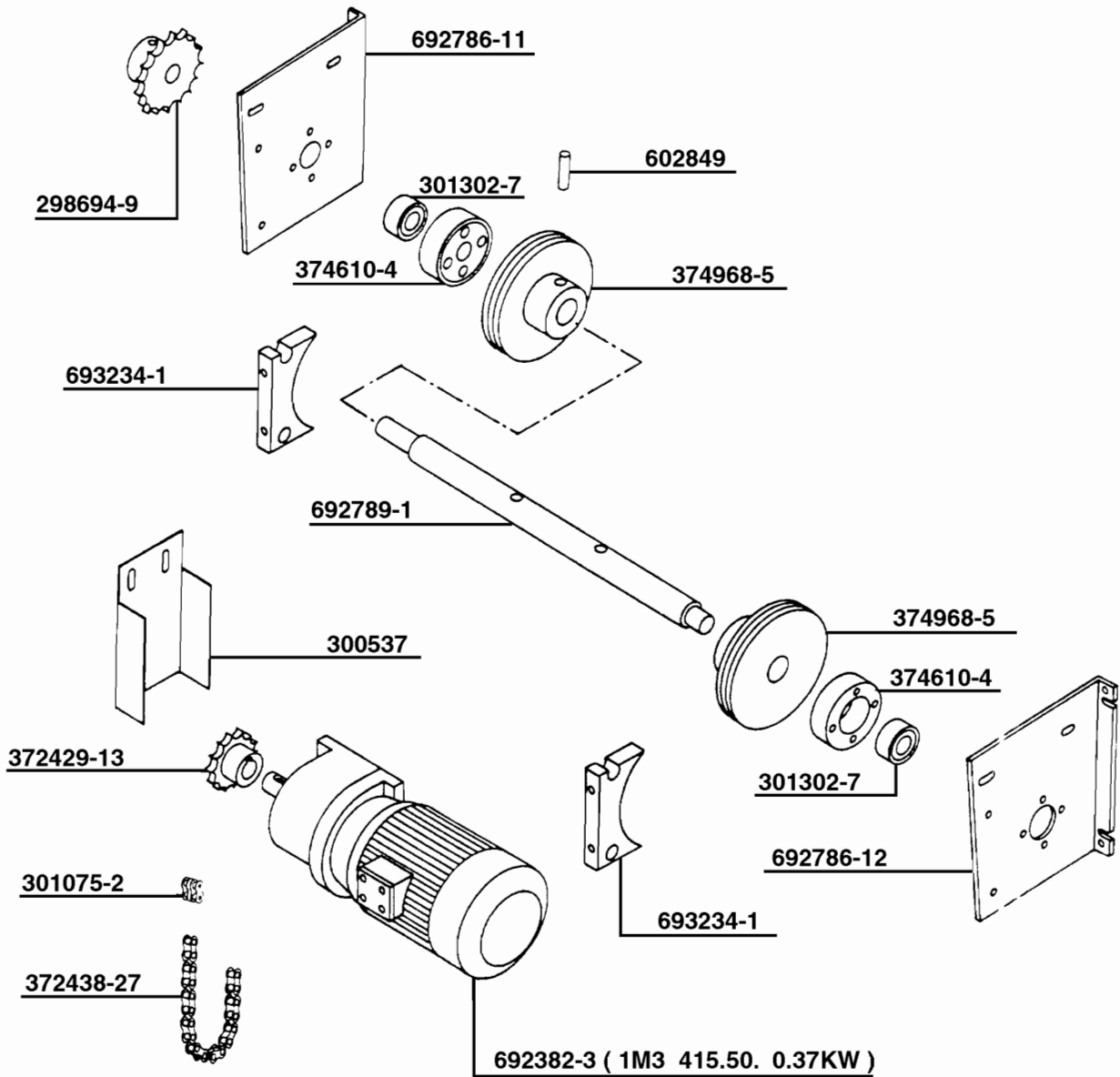
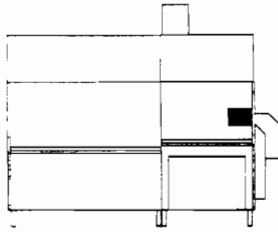

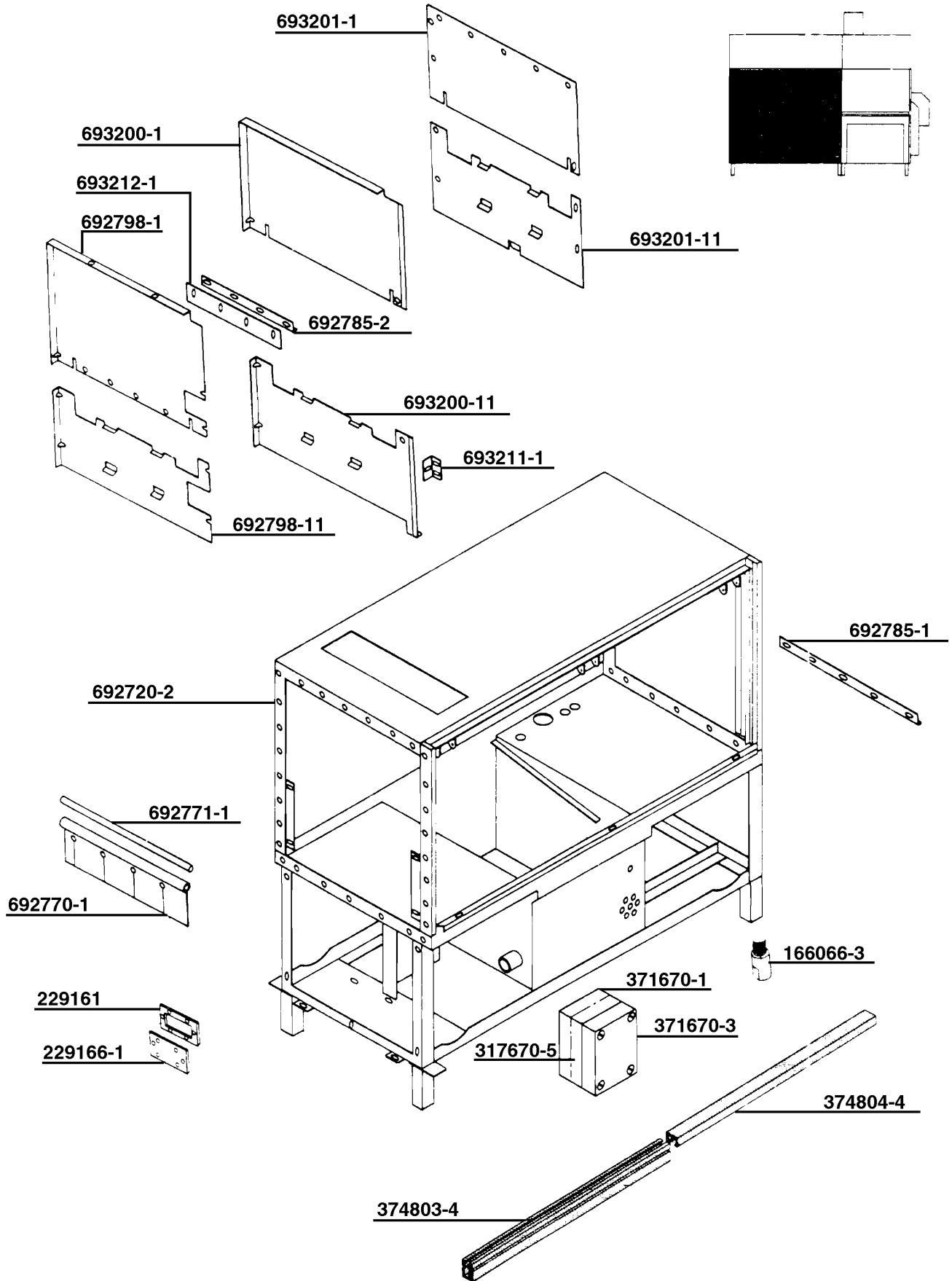

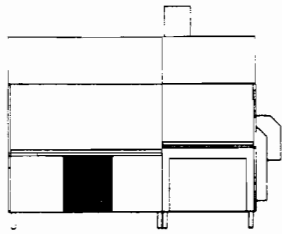

692774-1

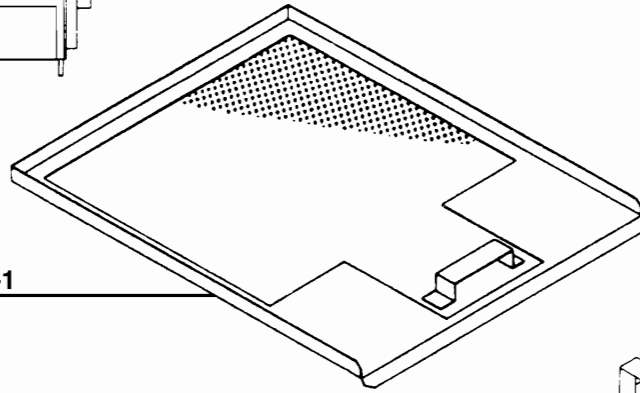

229400

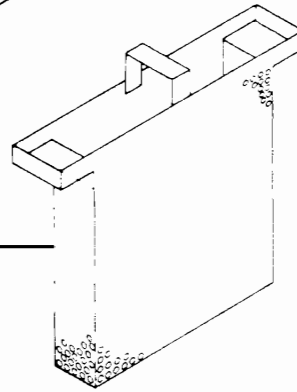

380098

230346-2

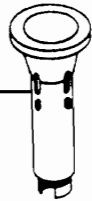

67500-15



226558-1



226556



229419

229394



380096



229566



229153



229155





Tank heating + Float switch  
Chauffage du bac + Interrupteur à flotteur  
Tankheizung + Schwimmer-Schalter

FTT ( L / R )

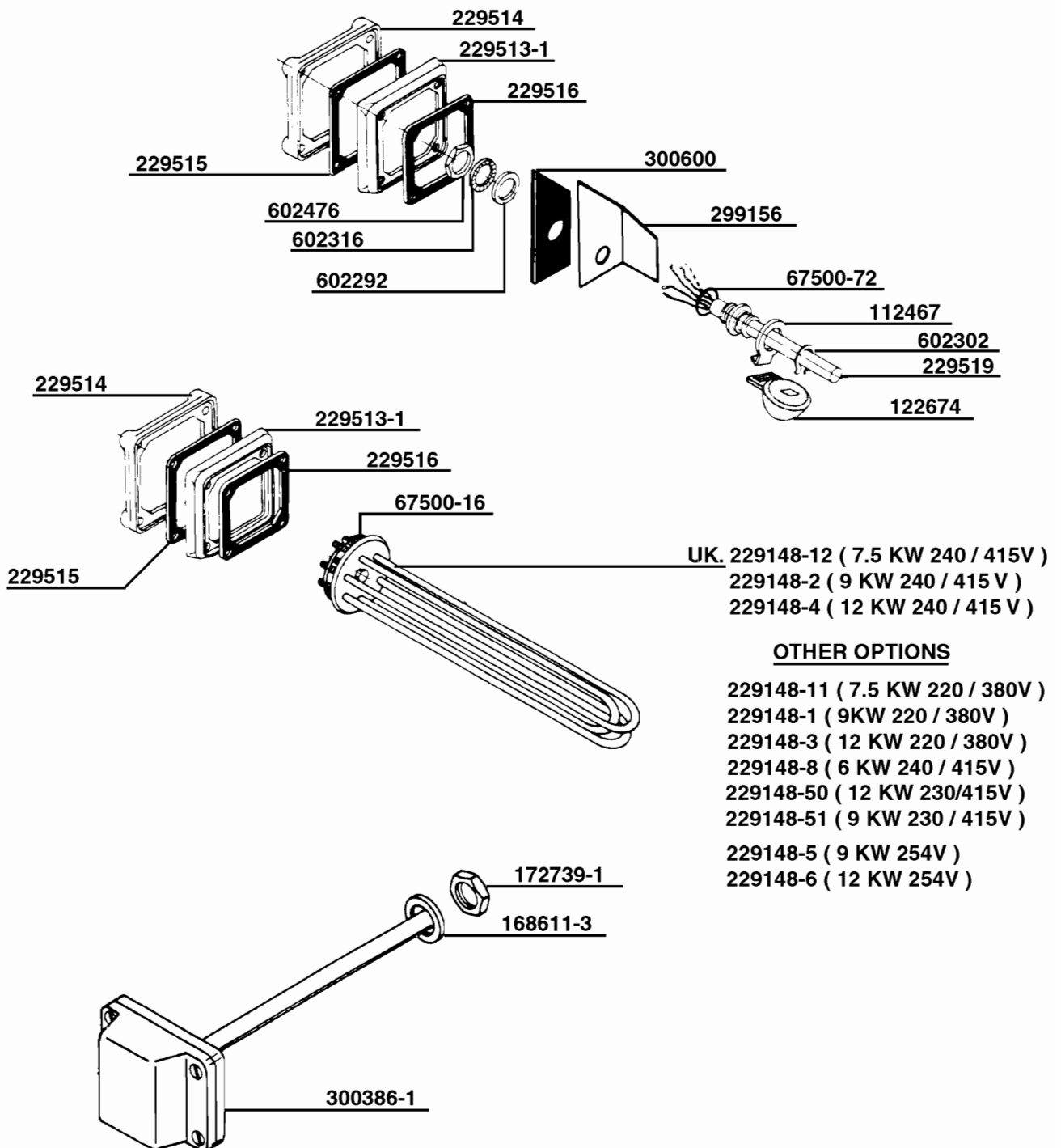

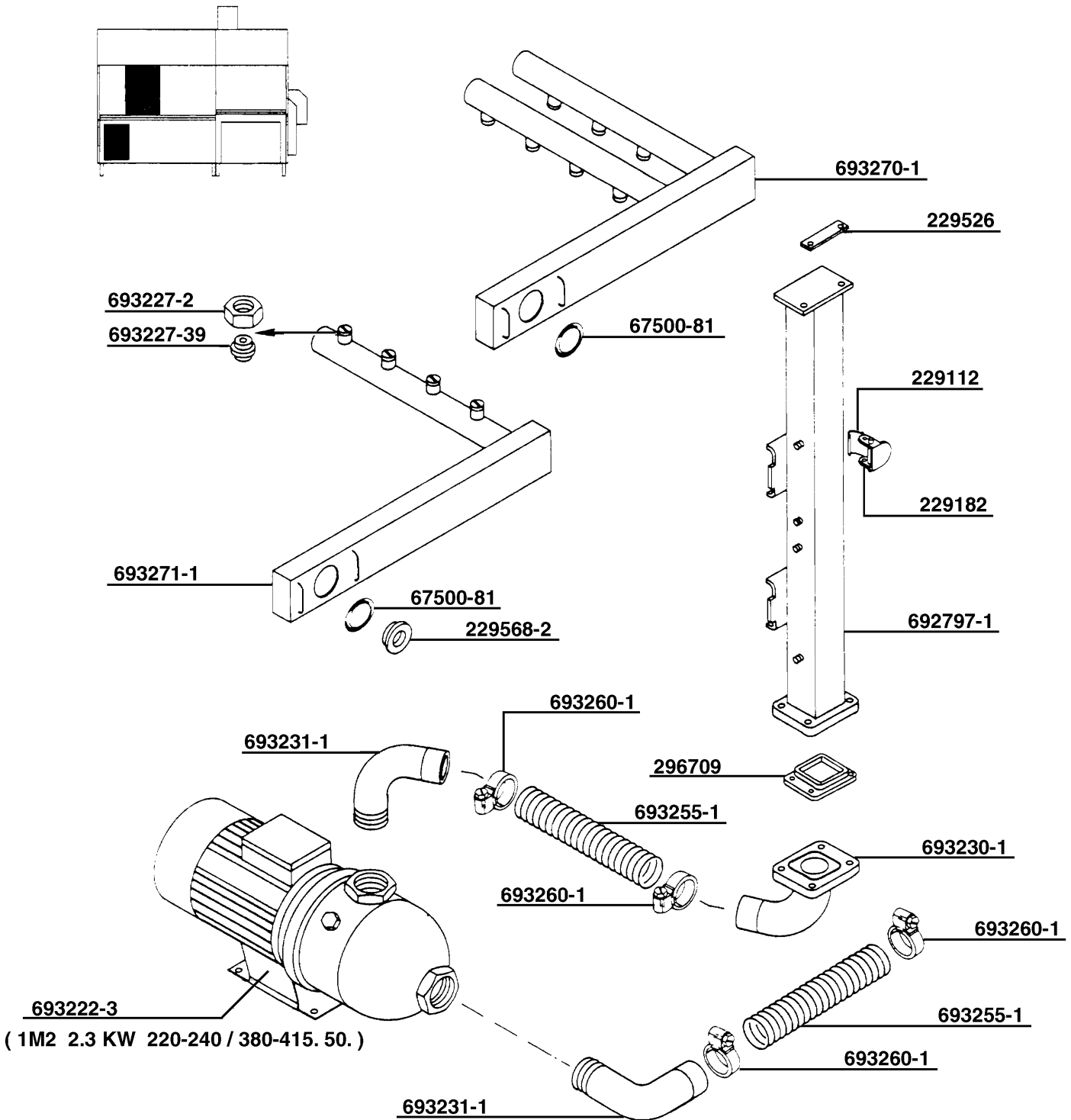



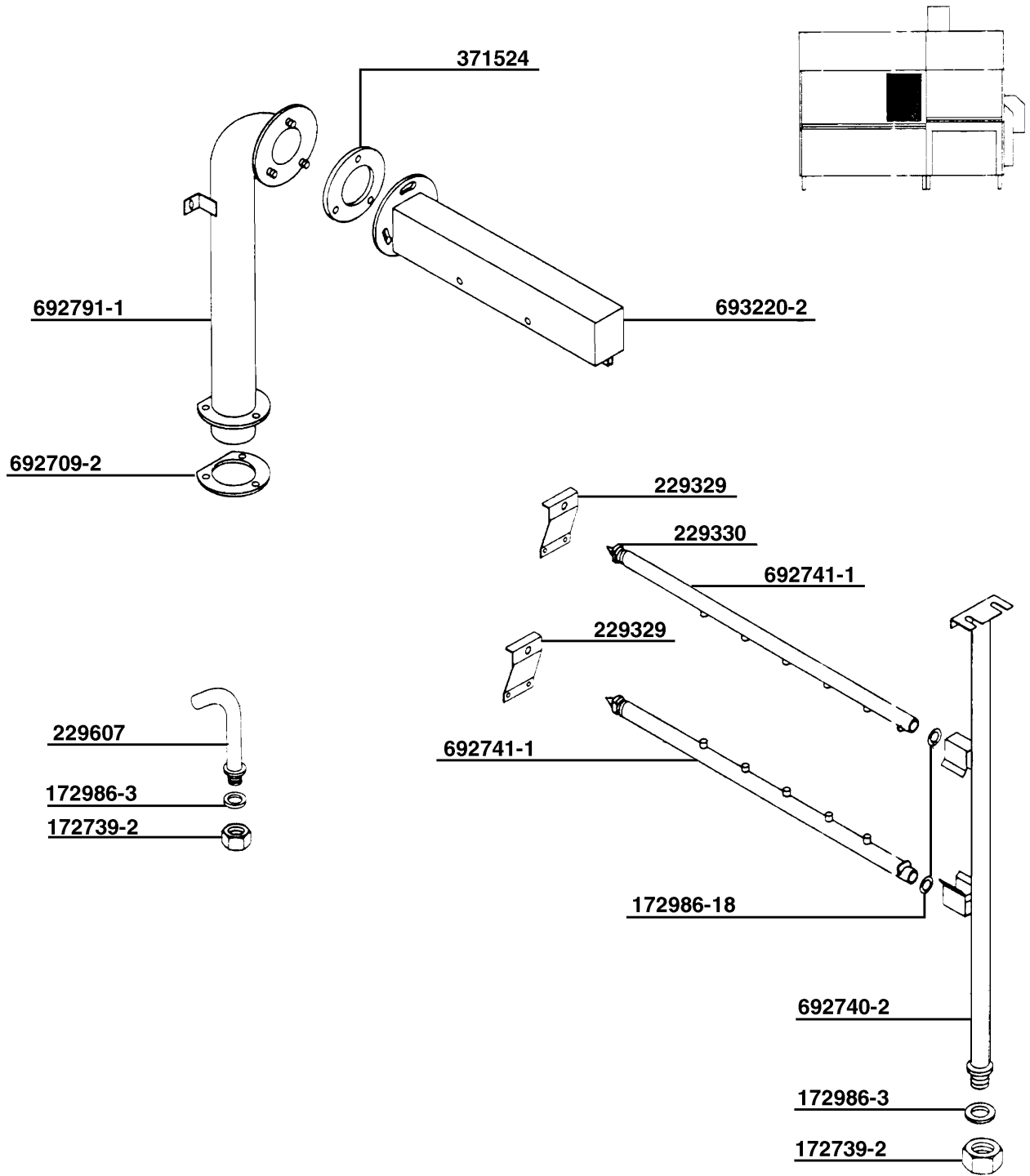

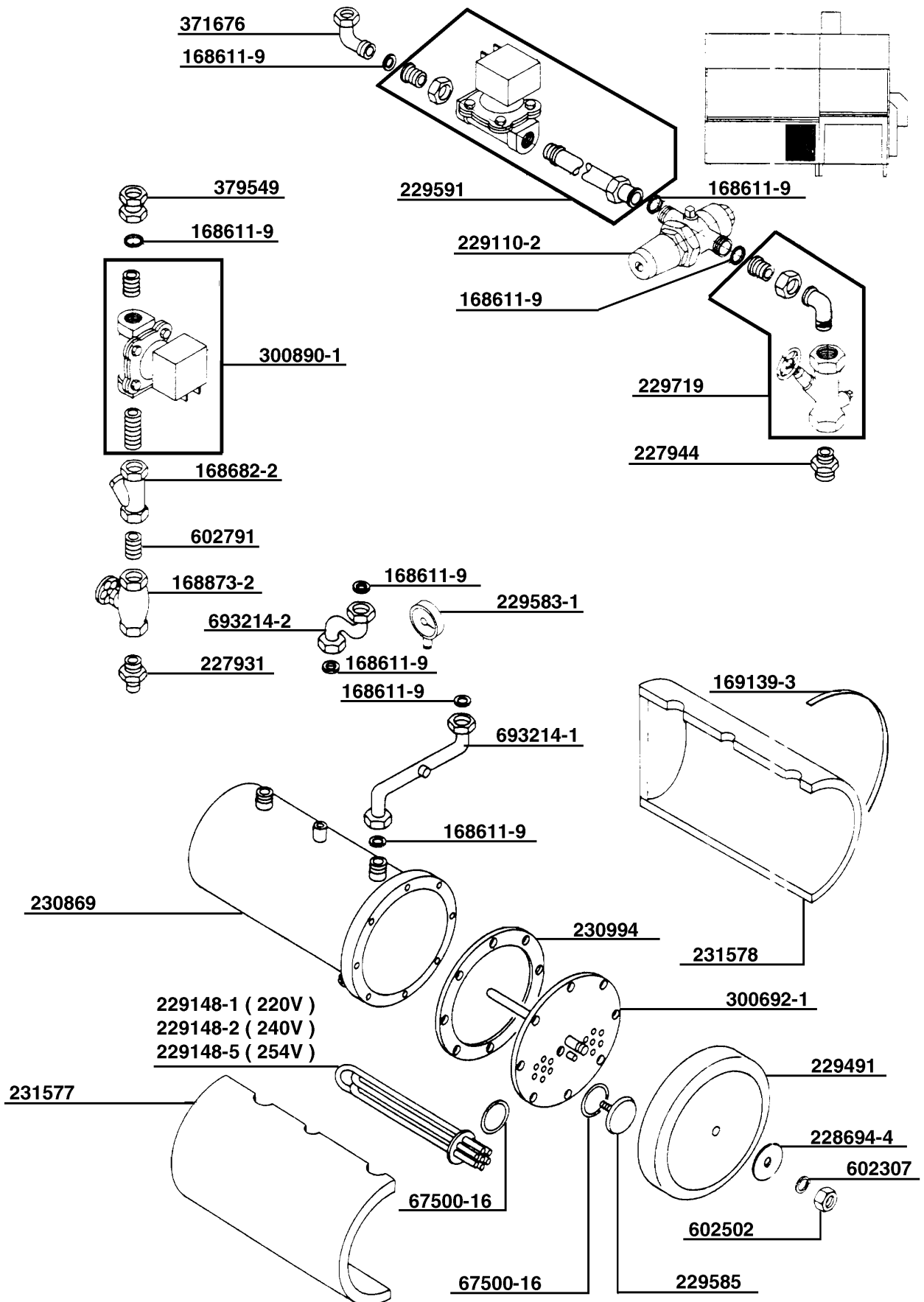



Booster 0,5m<sup>2</sup> hot water + Steam  
Chaudière 0,5m<sup>2</sup> eau chaude + Vapeur  
Durchlauferhitzer 0,5m<sup>2</sup> HW + Dampf

FTT ( L / R )

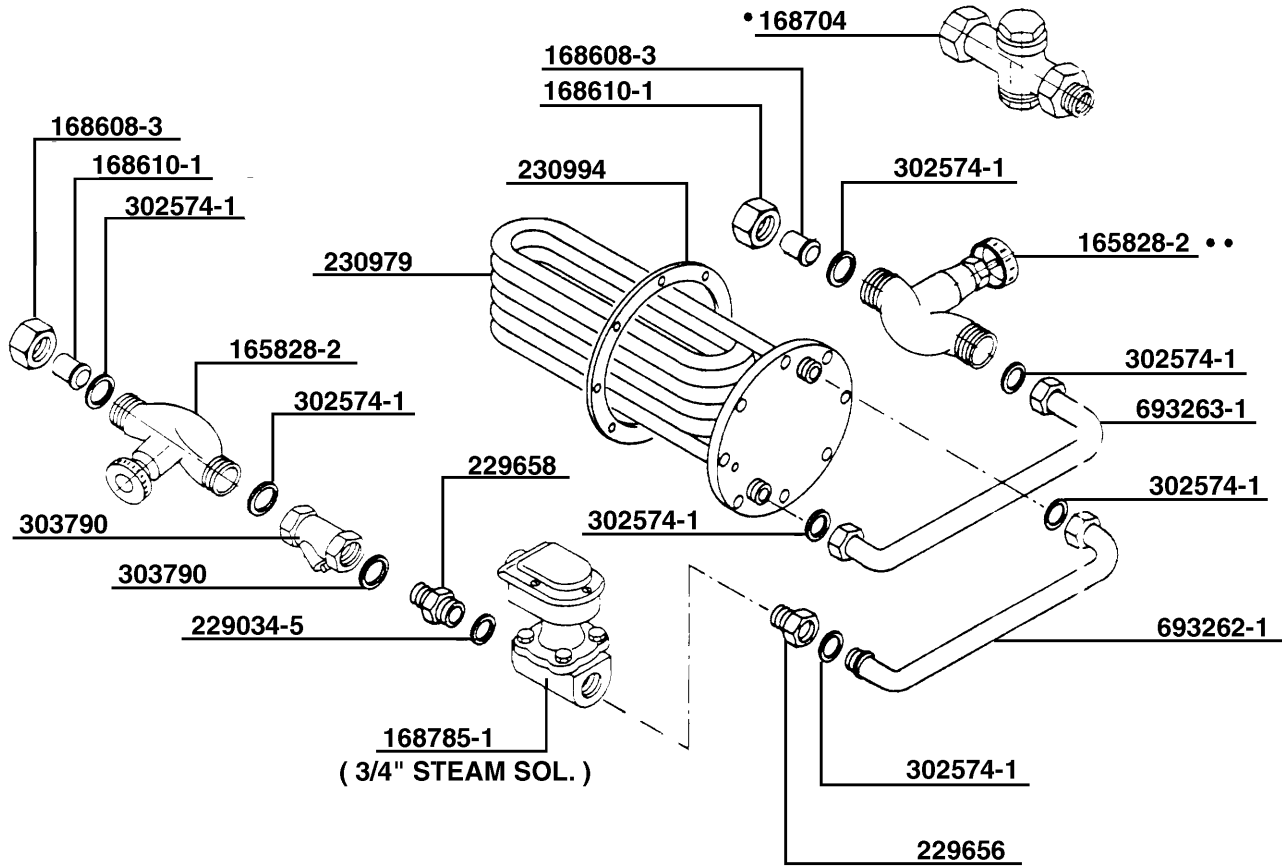
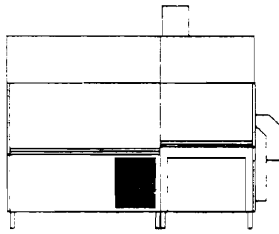

• STEAM  
VAPEUR  
DAMPF  
STOOM

•• HOT WATER  
EAU CHAUDE  
HEIBWASSER  
HEET WATER

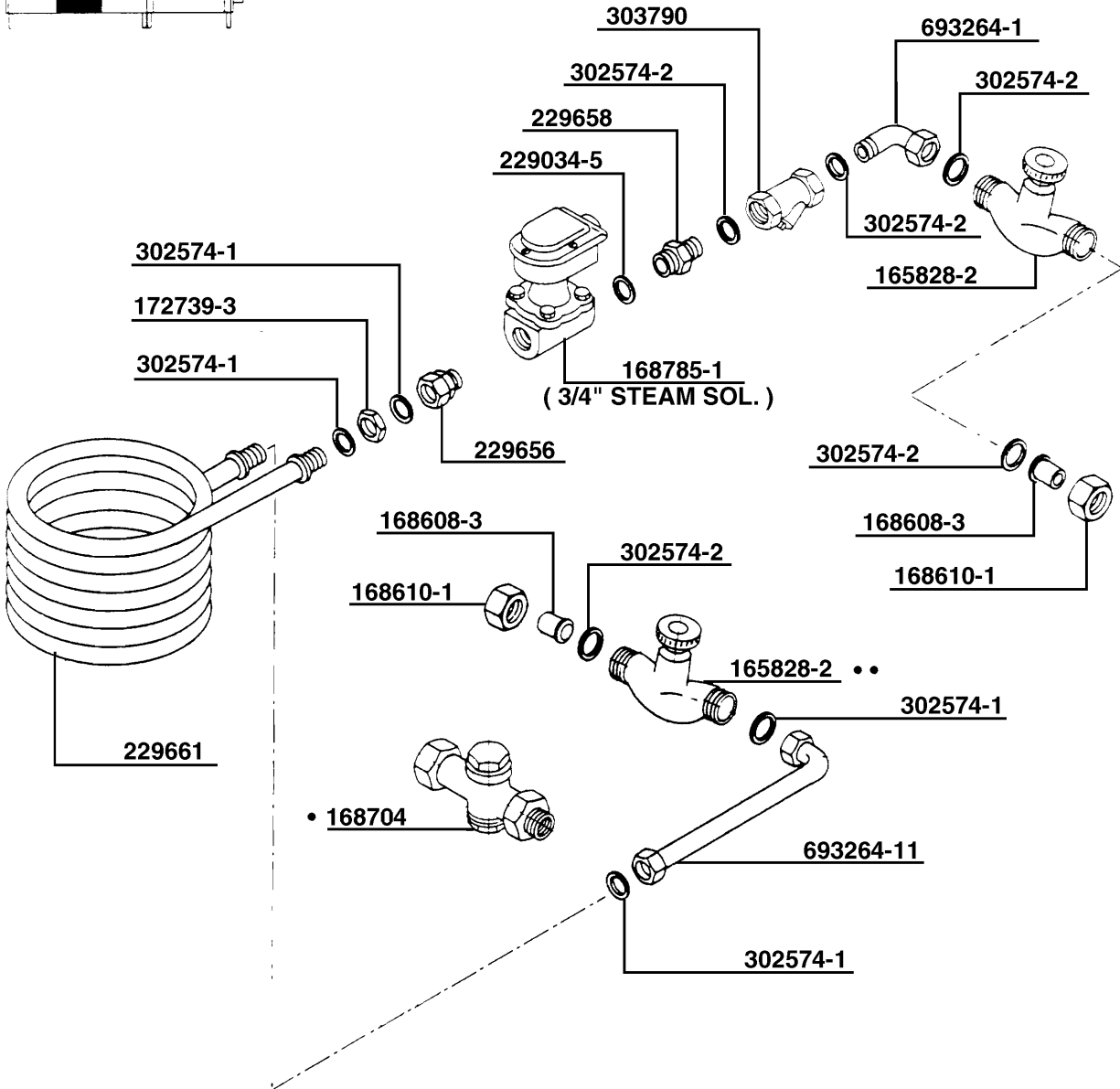
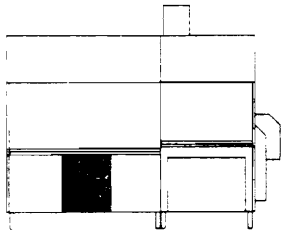

- STEAM  
VAPEUR  
DAMPF  
STOOM
- HOT WATER  
EAU CHAUDE  
HEIBWASSER  
HEET WATER



Panels + Insulation wash module 1400  
Habillage + Isolation module de lavage 1400  
Verkleidungen + Isolation Waschmodul 1400

FTT ( L / R )

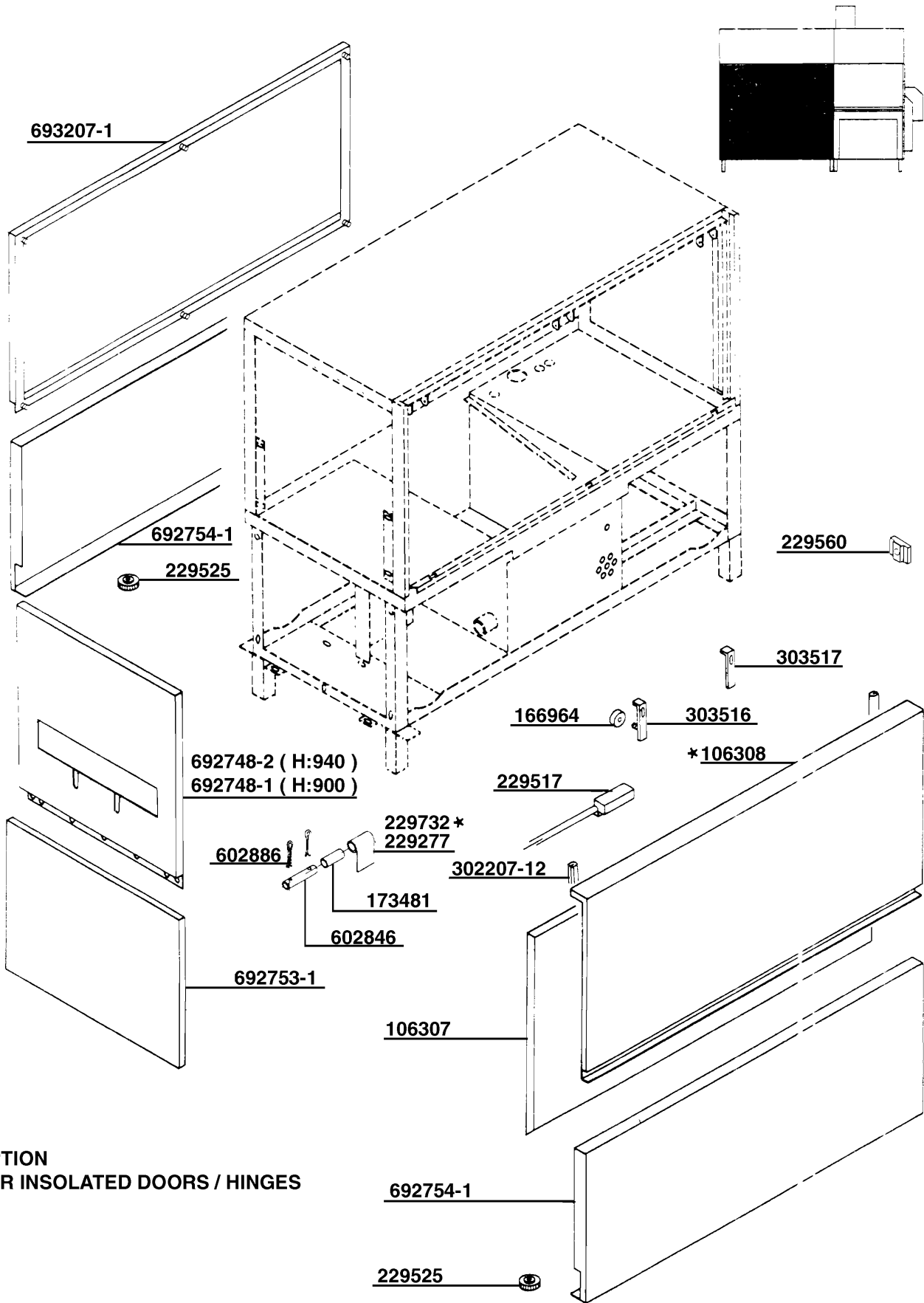

★ OPTION  
FOR INSOLATED DOORS / HINGES

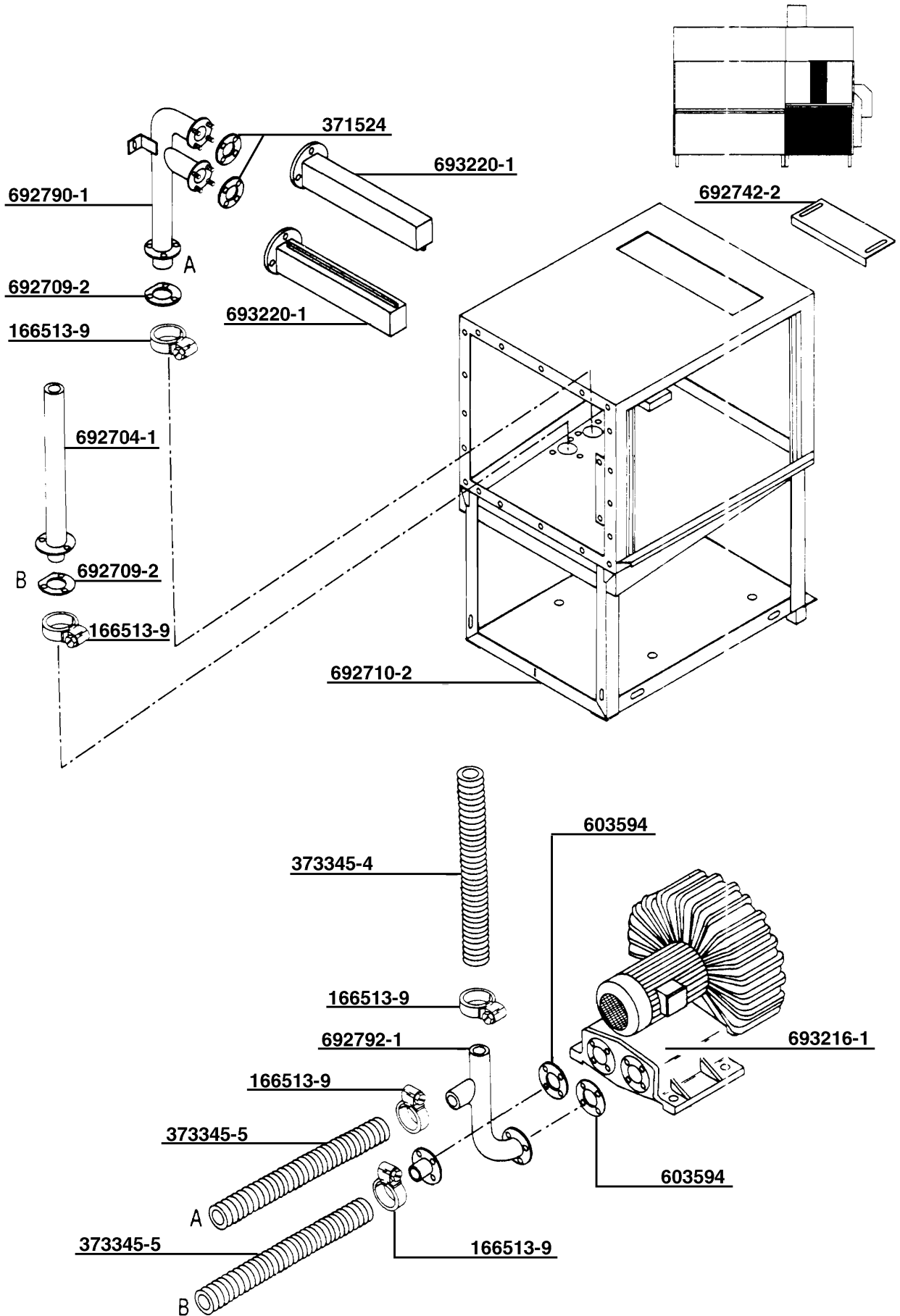

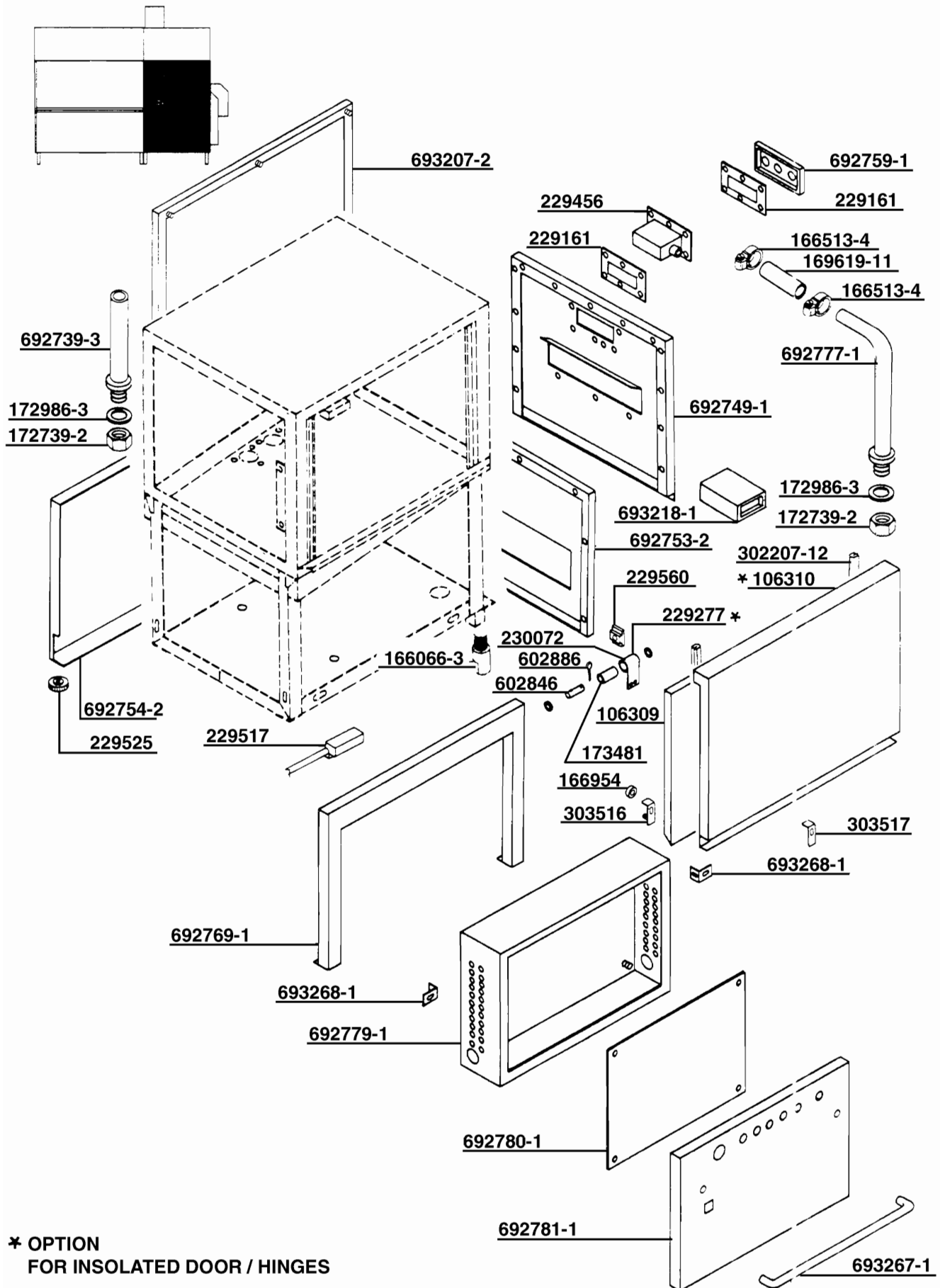

\* OPTION  
 FOR INSOLATED DOOR / HINGES

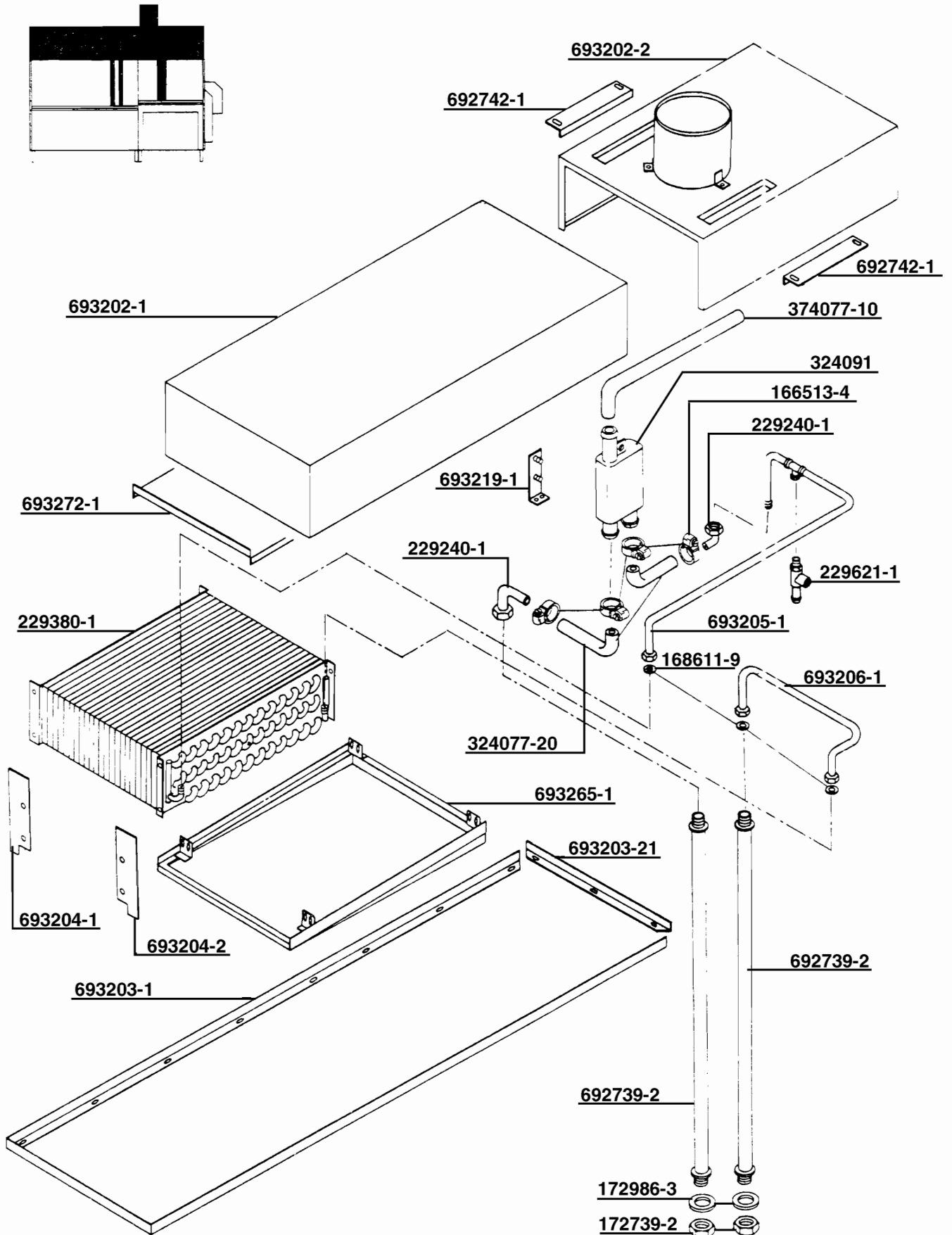



602660 ( M6 X 16 )

602286 ( DIA. 6.4 )

693877-1

B ( 5 X 5 X 25 )

145075-1

38933-13

602286 ( A6.4 )

602570 ( M6 X 16 )

230096

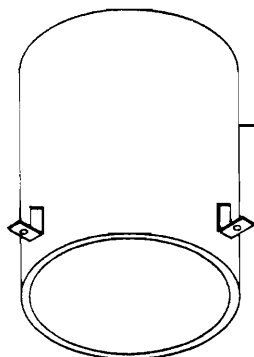
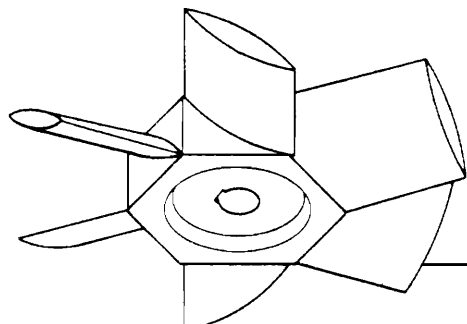
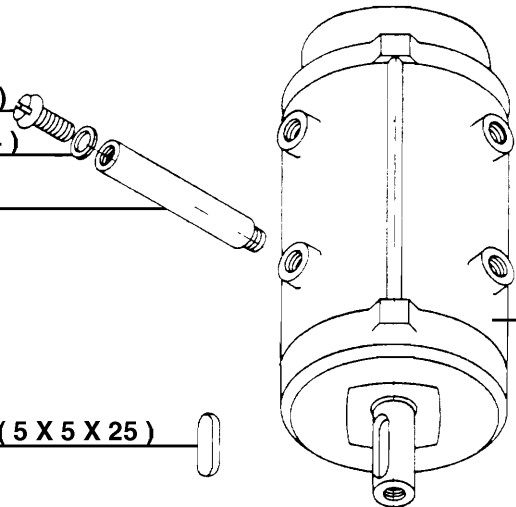
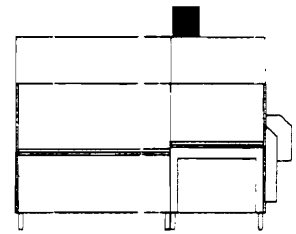

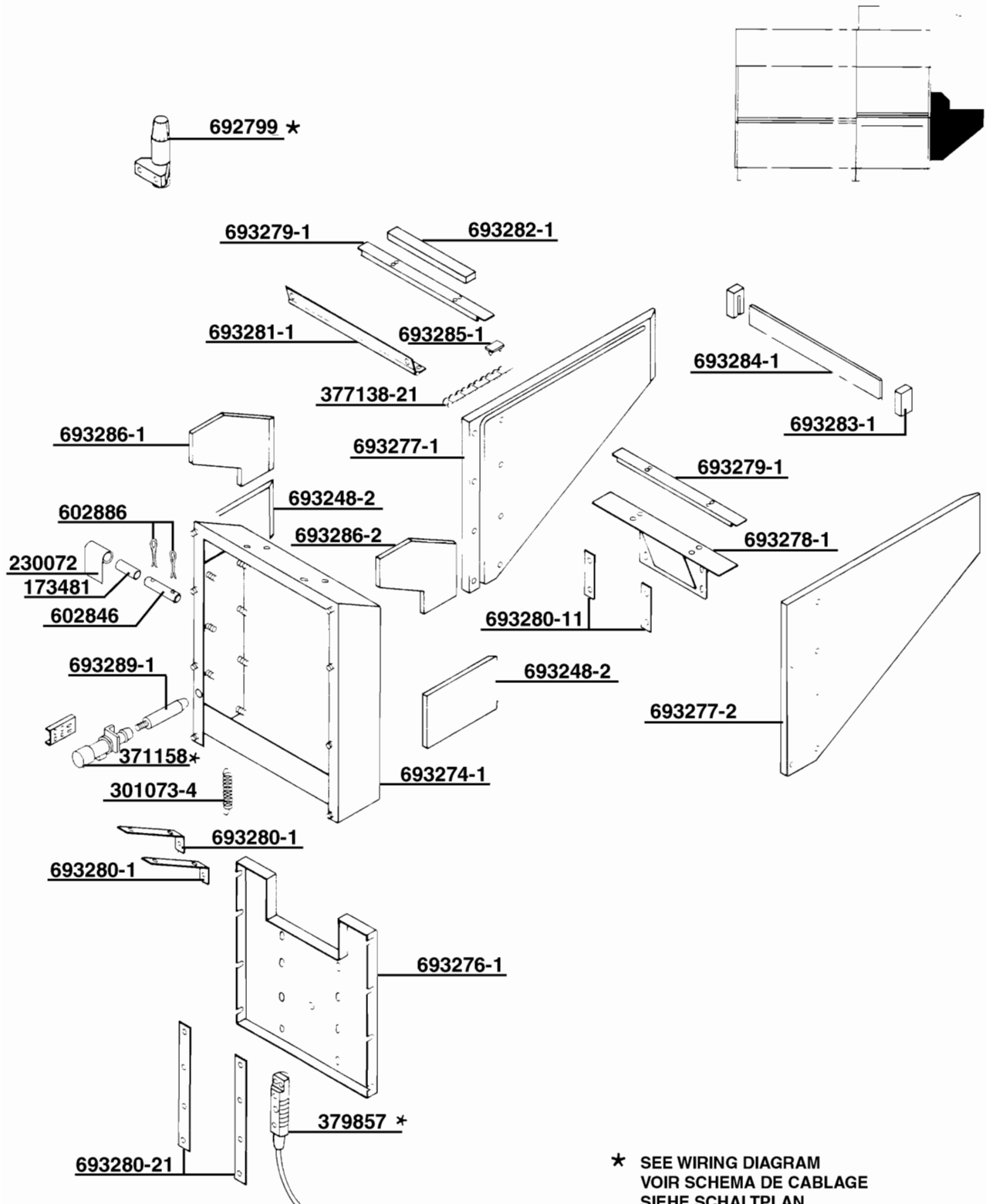

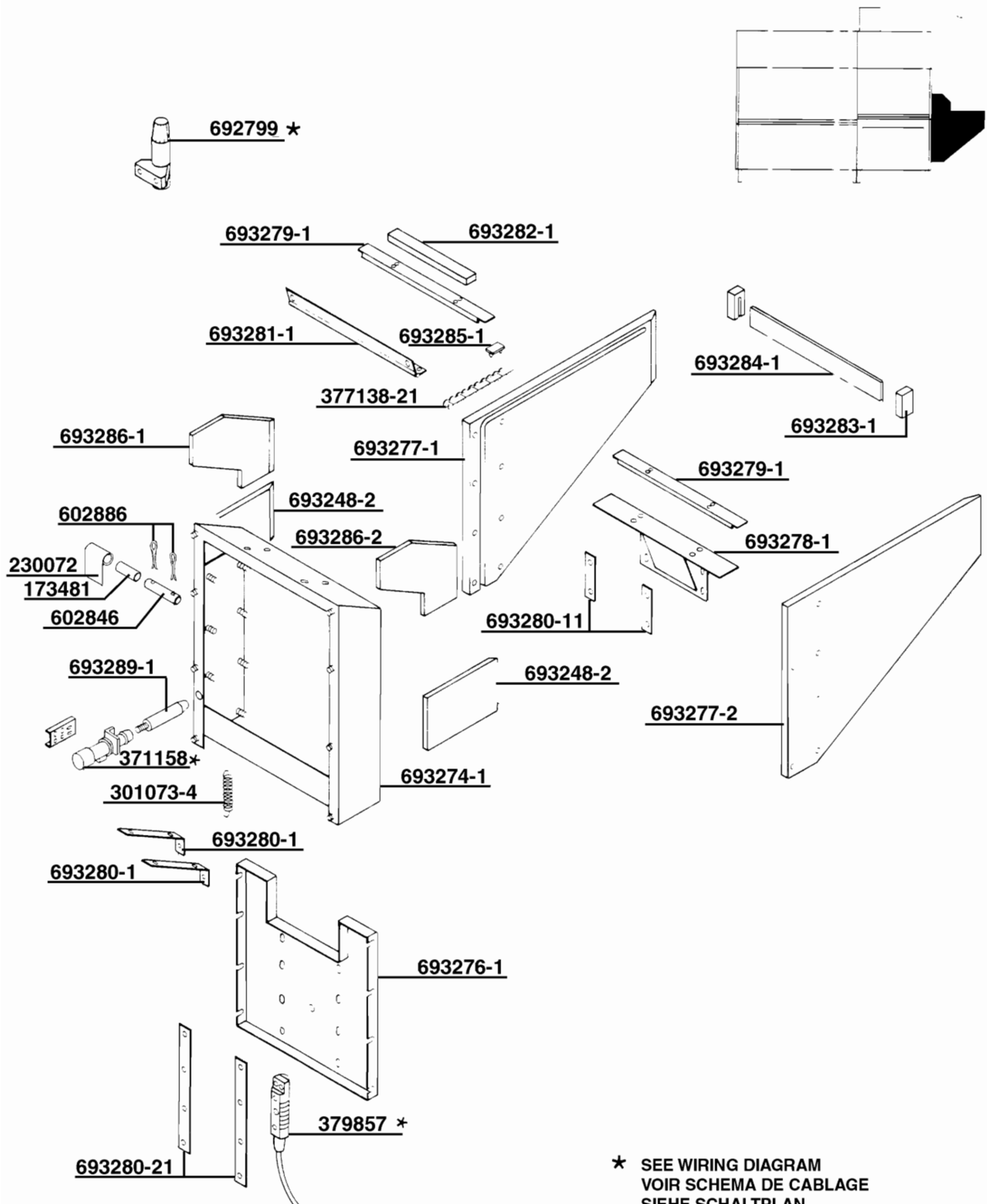

\* SEE WIRING DIAGRAM  
VOIR SCHEMA DE CABLAGE  
SIEHE SCHALTPLAN  
ZIE ELEKTRISCH SCHEMA